

# COLUMN LOUDSPEAKER

( WATER RESISTANT IP66 RATING )



BR-CLN

## SPECIFICATIONS

Model No.	CLN-3408BS	CLN-3204BS
Rated Power (rms)	40W	20W
Number of Loudspeakers	3.5" Woofer X8 + 3.25" Tweeter X1	3.5" Woofer X4 + 3.25" Tweeter X1
Power Rating(100V)	40W-20W-10W	20W-10W-5W
Power Rating(70V)	20W-10W-5W	10W-5W-2.5W
Impedance	250Ω- 500Ω-1KΩ	500Ω-1KΩ-2KΩ
S.P.L.( at 1W/1M )	93dB	92dB
MAX. S.P.L.( at Rated W/1M )	109dB	105dB
Frequency Response(-10dB)	110 Hz ~ 20K Hz	130 Hz ~ 20K Hz
Dispersion 1KHz / 4KHz	180° / 140°	180° / 120°
IP Rating	<b>IEC60529 IP66</b>	
Compliant Standard	<b>EN54-24</b>	
Power Selection	4-Port Ceramic Terminal Block	
Dimension	1016(L)x124(W)x108(D)mm	610(L)x124(W)x108(D)mm
Material	Housing: Aluminum Alloy , Grille: Aluminun	
Colour	White	
Weight	7.7Kgs	4.0Kgs
Mounting	Aluminum Alloy Multi Bracket(BR-CLN)	

# COLUMN LOUDSPEAKER

( WATER RESISTANT IP66 RATING )

CLN-3204BS

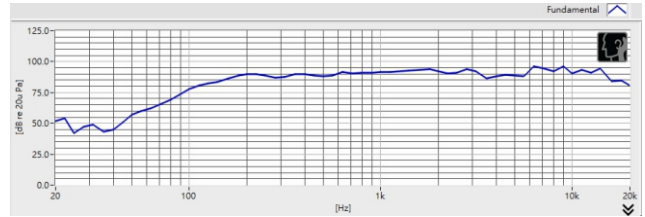
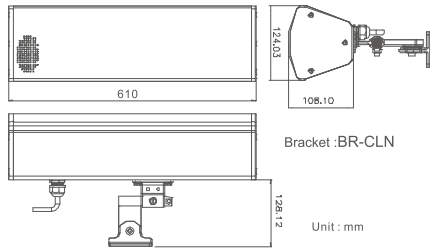

CLN-3408BS

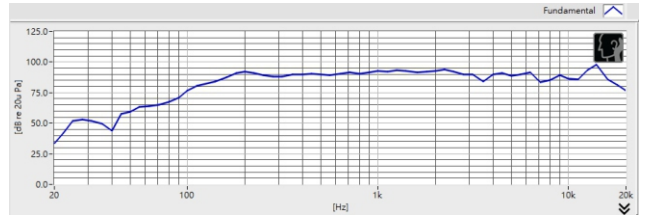
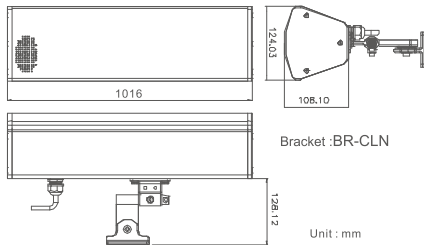

EN54-24 CERTIFICATED

CLN-xxxBS SERIES